

INSTALLATION

1. INSTALL THESE PARTS:

- (a) Reinforcement
- (b) No.1 brace
- (c) Floor brace
- (d) No.4 heater to register duct
- (e) No.3 heater to register duct

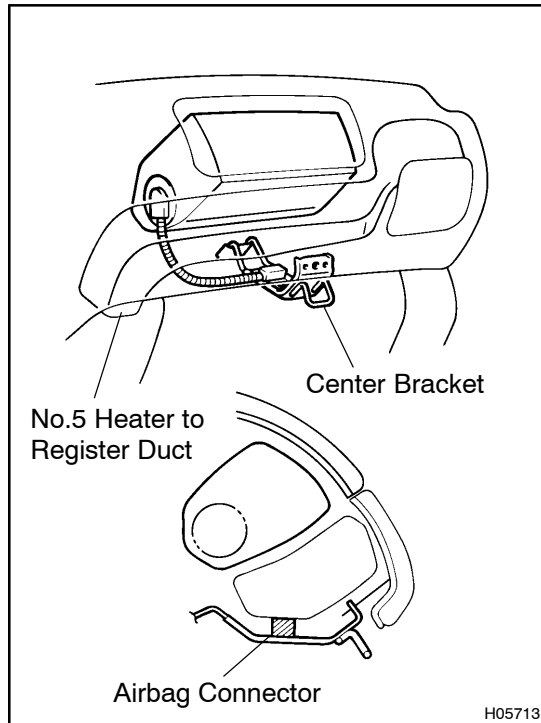

2. INSTALL INSTRUMENT PANEL

HINT:

- Install the airbag connector between the No.5 heater to register duct and center bracket temporarily, then install the instrument panel.
 - Remove the airbag connector before installing the lower No.2 panel.
- (a) Install the 6 bolts, 2 nuts and instrument panel, then connect the connectors.
 - (b) Install the 2 bolts to the front passenger airbag assembly.
Torque: 20 N·m (204 kgf·cm, 15 ft·lbf)
 - (c) Connect the junction connectors.

HINT:

The connectors can be connected by tightening the bolts.

3. INSTALL THESE PARTS:

- (a) Front console box
- (b) Center lower cluster finish panel
- (c) Rear console box
- (d) Rear heater control panel
- (e) Console rear end panel
- (f) Rear console panel
- (g) Radio assembly
- (h) Center cluster
- (i) Lower No.2 panel

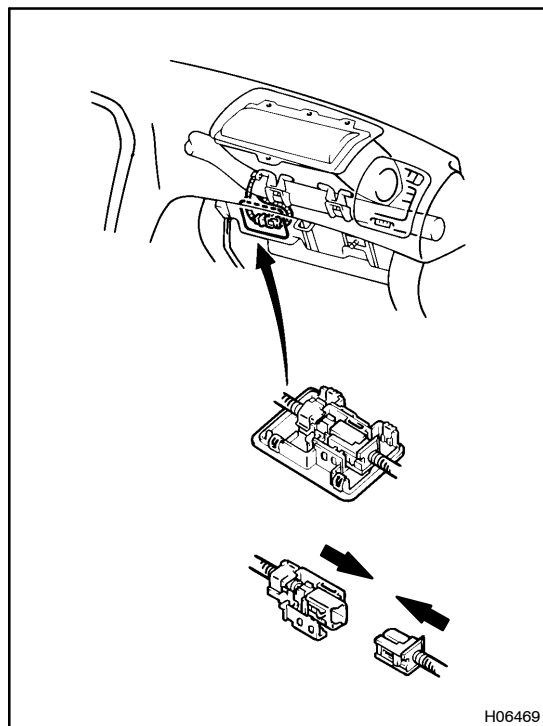

4. **CONNECT AIRBAG CONNECTOR**
(See page [RS-35](#))
5. **INSTALL GLOVE COMPARTMENT DOOR**

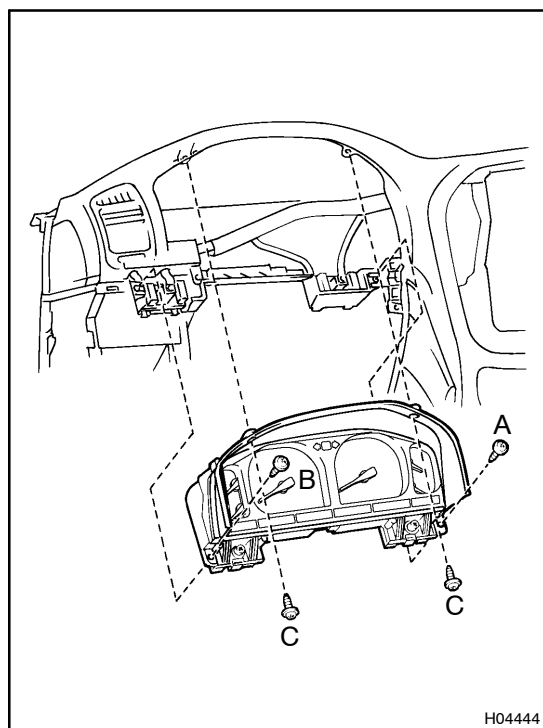

6. **INSTALL COMBINATION METER**
 - (a) Check that the set-in connectors are connected in the installation holes on the instrument panel securely.
 - (b) Place the combination meter on the instrument panel.
 - (c) Install the combination meter by tightening the screws, A, B and C in the order.

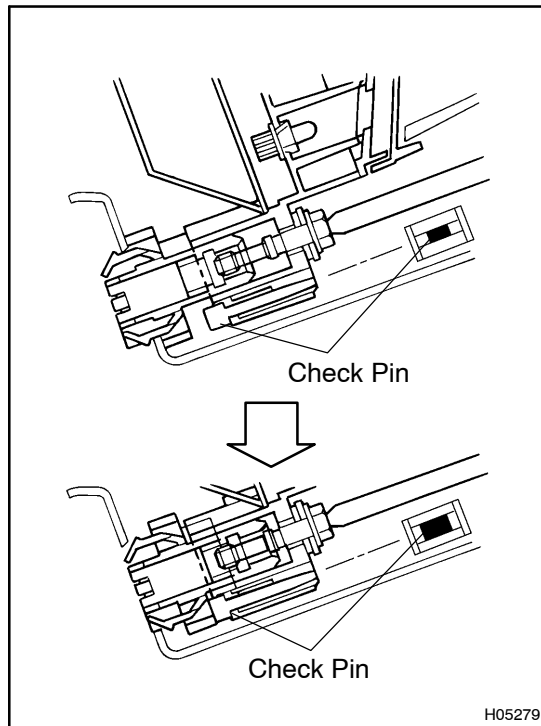

(d) Tighten the connection bolts.

HINT:

- When connection completes, the bolts turn vainly, causing turning noise.
- Check this noise and that the connection check pins protrude from the lower side of the connection bolts.

NOTICE:

Follow the procedures in order of (c) and (d). Otherwise, set-in connectors on the wire harness side and connectors on the meter side might not be connected properly.

7. INSTALL THESE PARTS:

- Steering column
(See page [SR-22](#))
- No.2 heater to register duct
- Combination switch
- Column cover
- LH lower panel
- Lower No.1 panel
- Hood lock and fuel lid control cable lever
- Cluster finish panel
- Steering wheel
(See page [SR-22](#))
- Front pillar garnishes
- Assist grips
- Front door opening trims
- Cowl side trims
- Front door scuff plates